

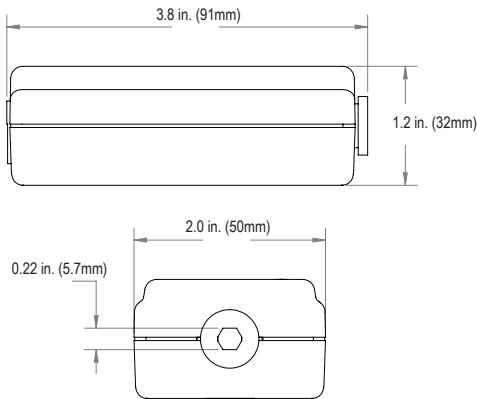



# AMPTILT-0.6/12

DC Wood Blind Tilt Motor with built-in RF control

High Profile Part # 62007000v2 | Low Profile Part # 62008000v2

dimensions

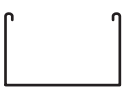

Headrail Adapters	System Type	Headrail Profile
 High Profile Headrail Adapter	2" x 2.25" (51mm x 57mm) High Profile Headrail	
 Low Profile Headrail Adapter	1.5" x 2.25" (38mm x 57mm) Low Profile Headrail	

specifications

Model	AMPTILT-0.6/12 H; AMPTILT-0.6/12 L
Torque	0.6Nm
Speed	12rpm (adjustable to 15 or 20)
Motor Size (L x W x H)	91mm x 50.0mm x 32.4mm
Voltage	12V DC
Current	0.6A
Power	7.2W
IP Class	IP20
Insulation Grade	A

Battery Model / Type	External Battery Pack (PN: 62203000)
Battery Capacity	2600mAh
Working temp	32°F to 140°F (0°C to 60°C)
RF Modulation	FSK
Radio Frequency	433.92 MHz
Max Running Circles	6 Minutes
Limit Switch Type	Electronic
Sound Level	50dB
Net Weight	0.3Lbs

features & applications



external battery for head rail

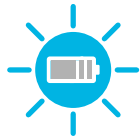

solar charging



bi-directional

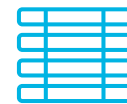

tilt only horizontal



app compatible

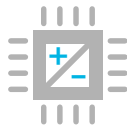

electronic limit



slow jog & tilt mode

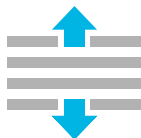

leveling control



favorite position



adjustable RPM

# AMPTILT-0.6/12

DC Wood Blind Tilt Motor with built-in RF control

High Profile Part # 62007000v2 | Low Profile Part # 62008000v2

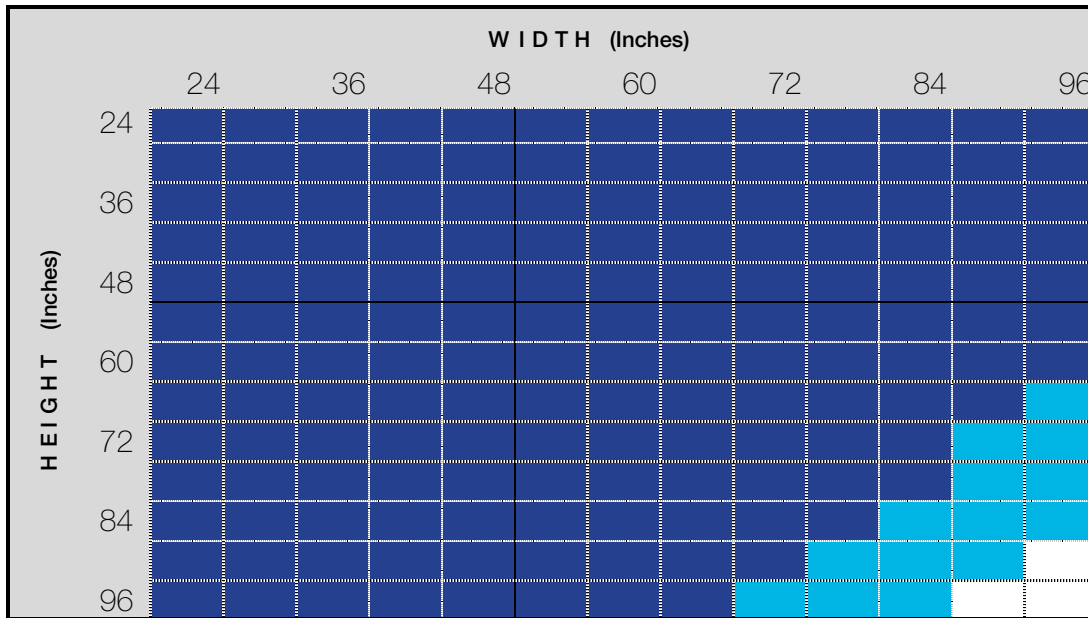

Under 80% Load



Between 80% Load and 100% Load

**Material:** 2" Faux Wood

**Bottom Rail:** 2" Faux Wood Trapezoid (Solid)